



# Thermal-Hinge Cover



## Features.

- One-handed, easy-open, hinged latch provides ventilation and egress.
- Saves energy. Fluted polycarbonate design increases the thermal performance of any basement window.
- Heavy duty construction withstands loads of more than 44 pounds per square foot.
- Sloped for runoff of rain, snow.
- Available in aluminum mill finish frame or white.
- Sizes to fit deluxe straight, Stif Back II and Garden Step area walls.
- Also available in special/custom sizes.



**MONARCH**  
Materials Group Inc.

P.O. Box 250, Waukee, IA 50263 515-993-4561 800-343-9370 [www.monmatgrp.com](http://www.monmatgrp.com)  
1850 W. Adriatic Pl., Englewood, Colorado 80110, Phone: (303) 935-4679, Fax: (303) 935-4670

THC01 6-09 5000

## SPECIAL SIZING THERMAL-HINGE COVER ORDER FORM

The Thermal-Hinge Cover requires a minimum of 5-1/2 inches from the top of your area wall to the top of the mounting flange. If distance is less than 5-1/2 inches, projection dimension "P" will need to be taken from the siding.

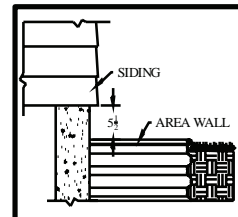

1.) Please **Select** the number that best represents the **Shape** of your Area Wall.

1.       2.       3.       4.       5.

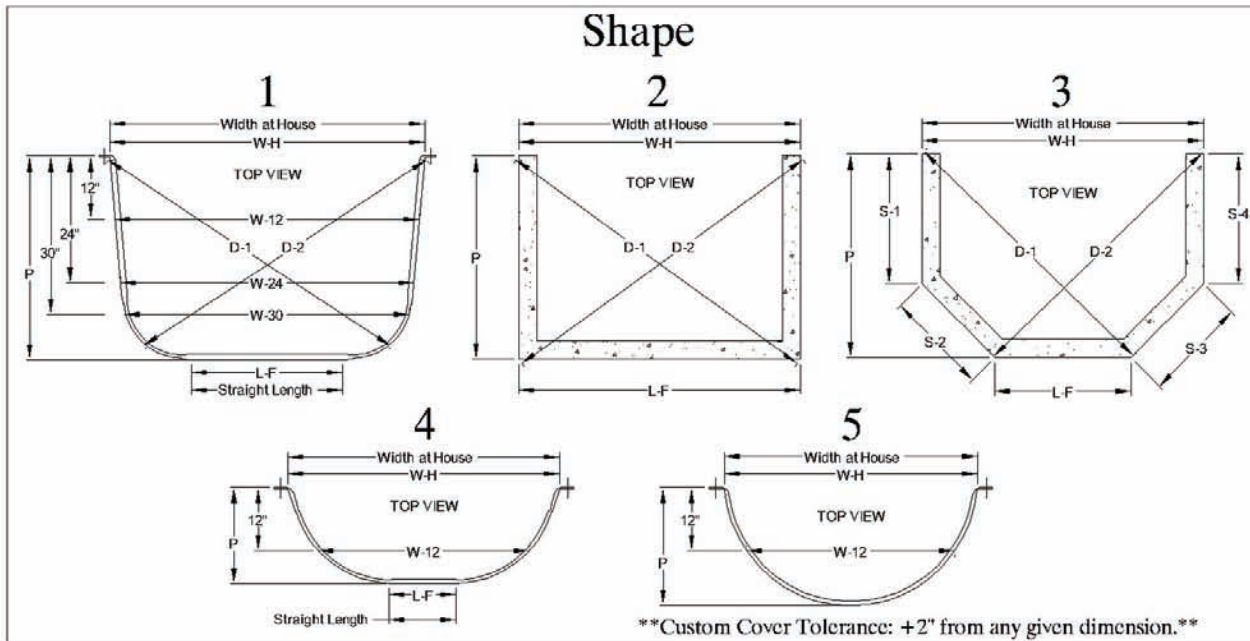

2.) Measure and write down the corresponding **outside to outside** measurements for your shape.

Width at House	Projection	Length Front	Diagonal	Diagonal	Width at 12"	Width at 24"	Width at 30"
W-H (Inches)	P (Inches)	L-F (Inches)	D-1 (Inches)	D-2 (Inches)	W-12 (Inches)	W-24 (Inches)	W-30 (Inches)
Section (For Shape 3 Only).							
S-1 (Inches)	S-2 (Inches)	S-3 (Inches)	S-4 (Inches)				

3.) Please **Select** which Area Wall Type you have?

- A.       B.       C.       D.       E.       F.       G.

4.) Please **Select** color: Mill Finish Aluminum

White

5.) Quantity: .....

Select Area Wall Type.

Steel Corrugation Pattern

A

B

C

---

D Concrete well.  
 E Wood well.  
 F Plastic well.  
 G Fiberglass well.

Customer Name: .....

Address: .....

City: ..... State: ..... Zip: .....

Phone: ..... Fax: ..... Email: .....